

CLARK CENTER

MAIN LEVEL

Main Entrance
Admissions
Museum Store
Michael Conforti Pavilion

LOWER LEVEL

Special Exhibition Gallery
Café 7
Erin Sherriff: Reminders
(through January 2, 2022)

SPECIAL
EXHIBITION
GALLERY

TO UPPER LEVEL →

Select galleries may be temporarily unavailable due to renovation work. These galleries are noted on the map with green shading.

We regret any inconvenience.

THE
CLARK

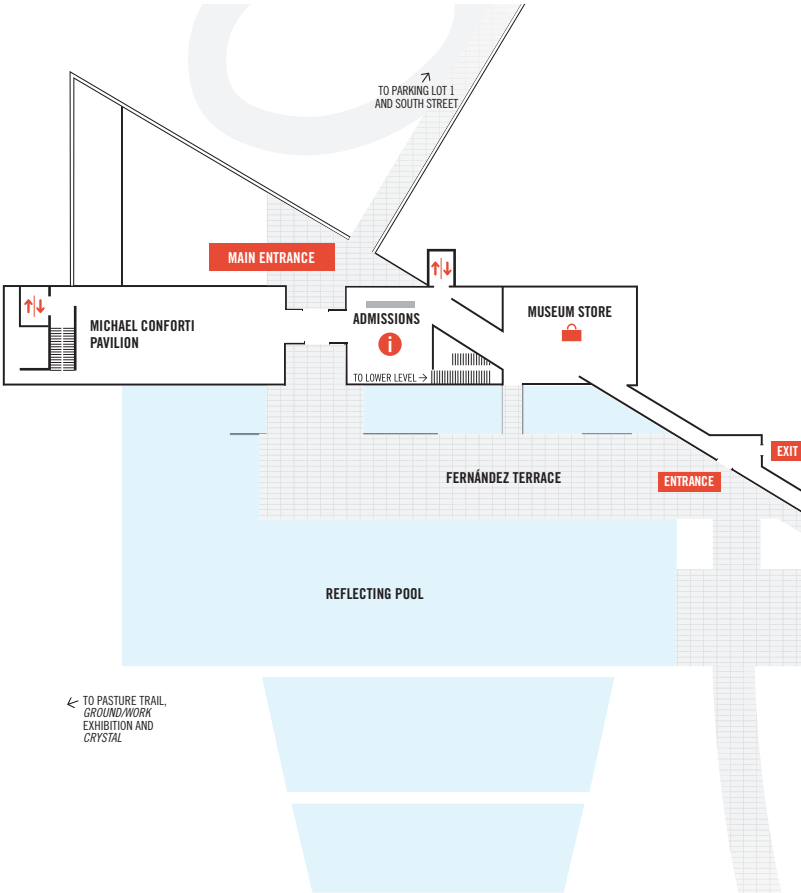

← TO PASTURE TRAIL,
GROUND/WORK
EXHIBITION AND
CRYSTAL

MANTON
RESEARCH CENTER

MAIN LEVEL

Manton Gallery for British Art
Eugene V. Thaw Gallery for Works on Paper
Manton Study Center for Works on Paper
Library
Auditorium
Erin Sherriff: Reminders
(through January 2, 2022)

← TO WALKING TRAILS,
GROUND/WORK
EXHIBITION AND
LUNDER CENTER

MUSEUM BUILDING

During May 2021, select galleries will be temporarily unavailable due to a renovation project. We regret the inconvenience.

- | | |
|---|---------------------------|
| 1 American Art 1850–1900 (partial) | 9 European Art 1450–1600 |
| 2 Impressionist Paintings—late 19th Century | 10 European Art 1300–1500 |
| 3 European and American Art 1850–1900 | 11 European Art 1700–1850 |
| 5 European Decorative Arts 1700–1800 | 12 Pastels |
| 6 European Art 1800–1850 | 13 European Art 1850–1900 |
| 7 Special Installations | 14 Edgar Degas |
| 8 European Art 1550–1650 | |

The Clark's gallery capacities are currently reduced in compliance with Massachusetts COVID-19 guidelines. Please observe posted occupancy signage.

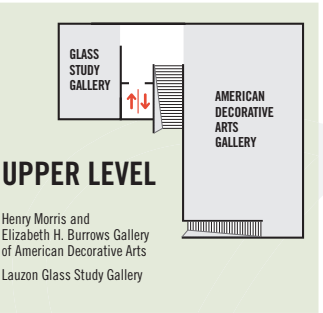
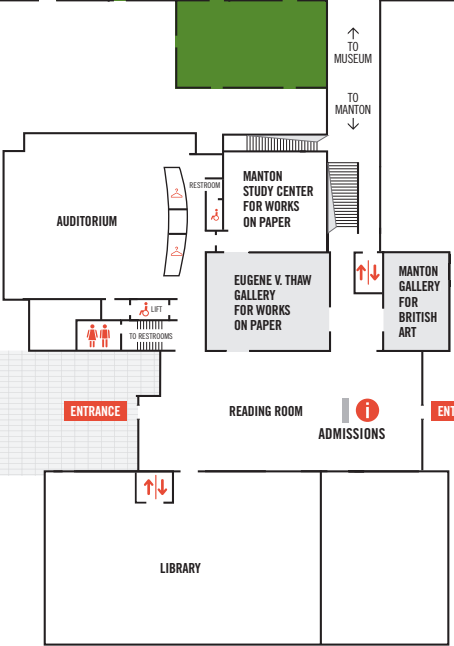

UPPER LEVEL

Henry Morris and
Elizabeth H. Burrows Gallery
of American Decorative Arts
Lauzon Glass Study Gallery

PARKING LOT 2